

Car Park

View C

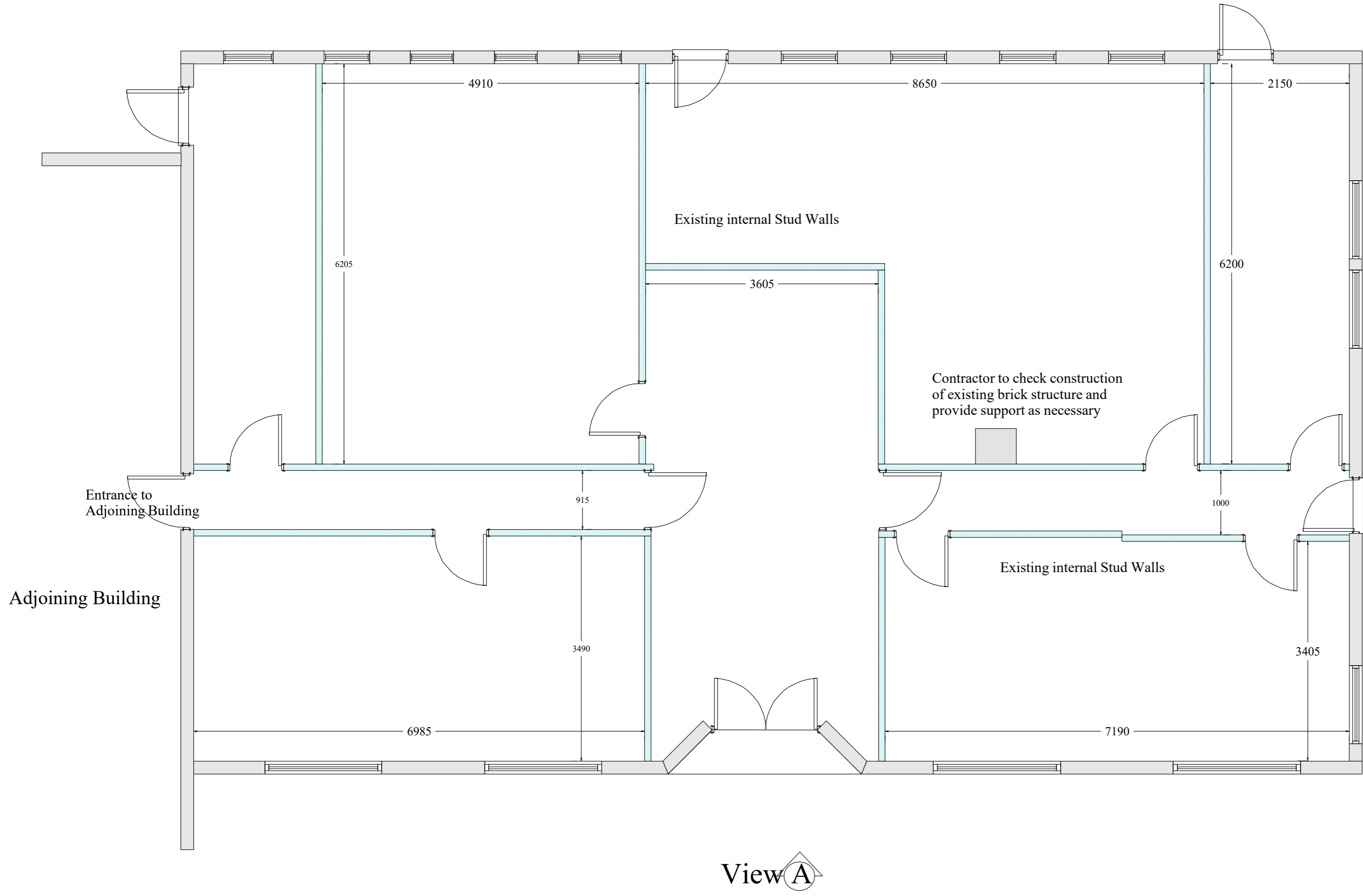

Car Park

View

B

- Notes;
- 1 This drawing is a copy right of LDL
 - 2 All dimensions must be checked before commencement of any works and inform the client of any discrepancies, before start of any works
 - 3 This drawing may not be copied without prior approval from Line Design Limited
 - 4 All building works to comply with Building regulations
 - 5 These drawings are prepared taking pre-construction design as to CDM 2015 regulations. The client is required to comply with pre-construction and construction phase of the CDM 2015 regulations
 - 6 Contractor to check all specifications and drawings prior to commencement of works and inform the client of any discrepancies.
 - 7 Refer to structural, mechanical, electrical specifications and clients instructions.
 - 8 Party Wall Act, would apply and the client to make arrangement with neighbouring properties before commencement of works.
 - 9 The builder will be fully responsible for the building works, to make all relevant building regulations application, liaison with building inspector and provide all relevant certificates on completion.

Revision	Description	Date

Project: **Sri Guru Singh Sabha
Park Avenue, Southall**

Project Title:
**Removal of internal Timber
walls and Support to
Roof Structure**

Drawing No: B201	Revision:
Date: July 2024	Drawn by: AS
Scale: 1/50 @A2	Chkd by: MK

Line Design Ltd
17A King Edward Road
Ruislip, Middlesex,
HA4 7AE
Tel: 07904 579357,
email: linedesign20@gmail.com

Park Avenue

